



US 20150021589A1

(19) **United States**(12) **Patent Application Publication**  
**CHUNG et al.**(10) **Pub. No.: US 2015/0021589 A1**(43) **Pub. Date: Jan. 22, 2015**(54) **ORGANIC LIGHT-EMITTING DISPLAY  
DEVICE****Publication Classification**(71) Applicant: **SAMSUNG DISPLAY CO., LTD.**,  
Yongin-City (KR)(72) Inventors: **Jin-Koo CHUNG**, Yongin-City (KR);  
**Sang-Hoon YIM**, Yongin-City (KR);  
**Chan-Young PARK**, Yongin-City (KR);  
**Jun-Ho CHOI**, Yongin-City (KR);  
**Seong-Min KIM**, Yongin-City (KR)(51) **Int. Cl.**  
**H01L 27/32** (2006.01)  
**H01L 51/52** (2006.01)(52) **U.S. Cl.**  
CPC ..... **H01L 27/3272** (2013.01); **H01L 27/3234**  
(2013.01); **H01L 27/3211** (2013.01); **H01L**  
**51/5221** (2013.01); **H01L 51/5218** (2013.01)  
USPC ..... **257/40**(21) Appl. No.: **14/511,249**(22) Filed: **Oct. 10, 2014****Related U.S. Application Data**(62) Division of application No. 13/137,977, filed on Sep.  
22, 2011, now Pat. No. 8,860,027.(30) **Foreign Application Priority Data**

Apr. 21, 2011 (KR) ..... 10-2011-0037348

**ABSTRACT**

Embodiments may disclose an organic light-emitting display device including a first substrate including a pixel area emitting light in a first direction, and a transmittance area that is adjacent to the pixel area and transmits external light; a second substrate facing the first substrate and encapsulating a pixel on the first substrate; an optical pattern array on the first substrate or the second substrate to correspond to the transmittance area, the optical pattern array being configured to transmit or block external light depending on the transmittance area according to a coded pattern; and a sensor array corresponding to the optical pattern array, the sensor array being arranged in a second direction that is opposite to the first direction in which the light is emitted, the second array receiving the external light passing through the optical pattern array.

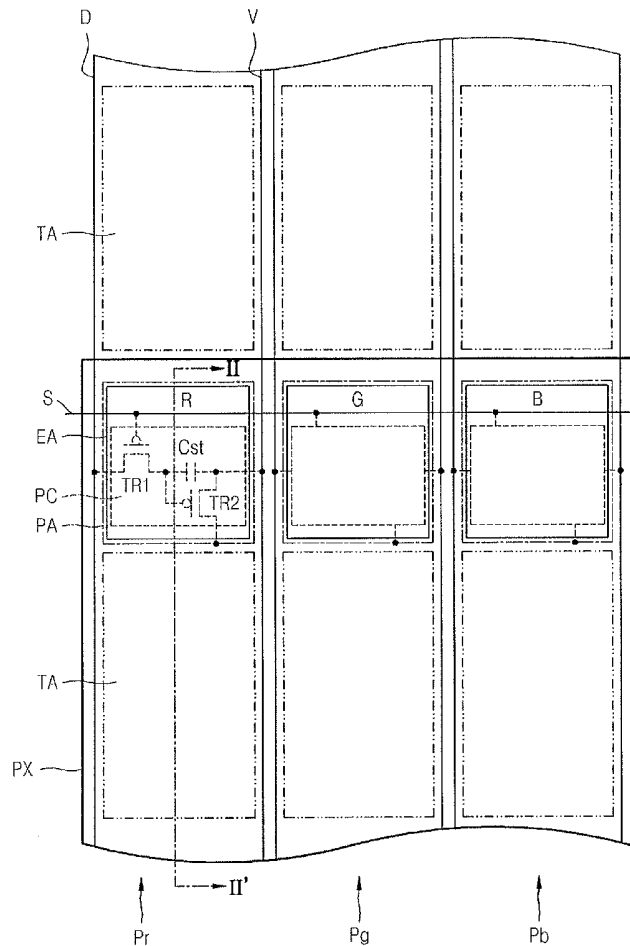

FIG. 1

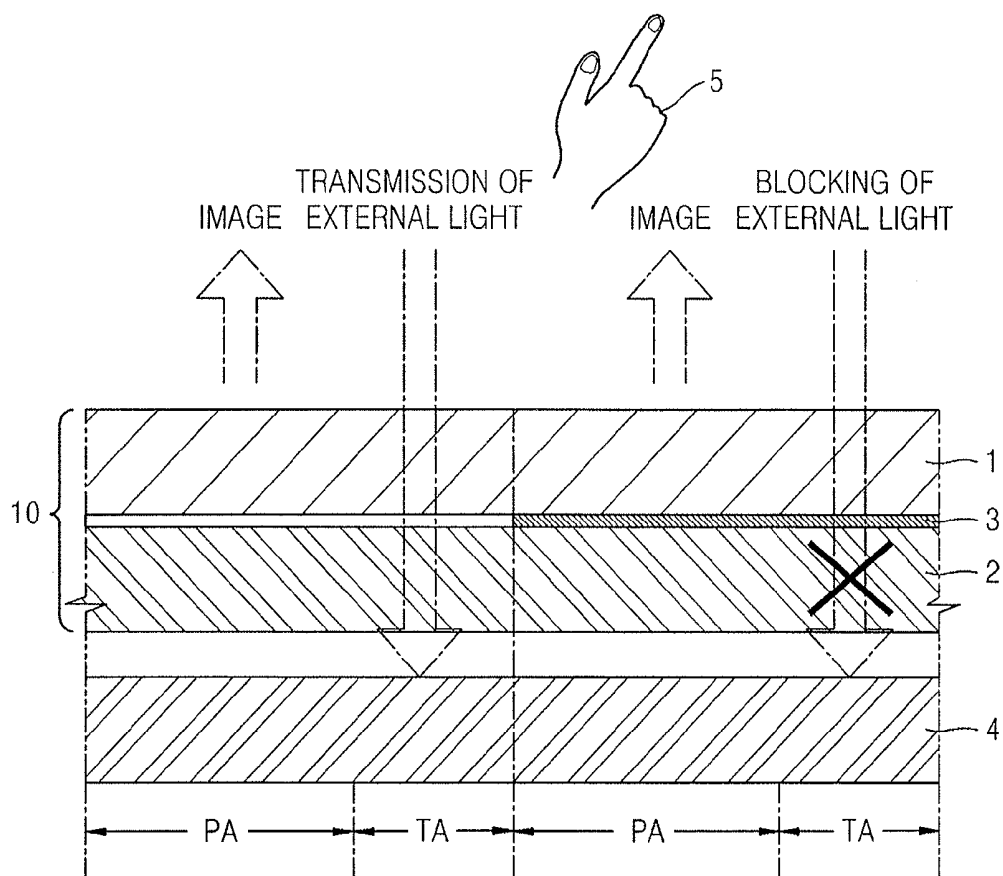

FIG. 2

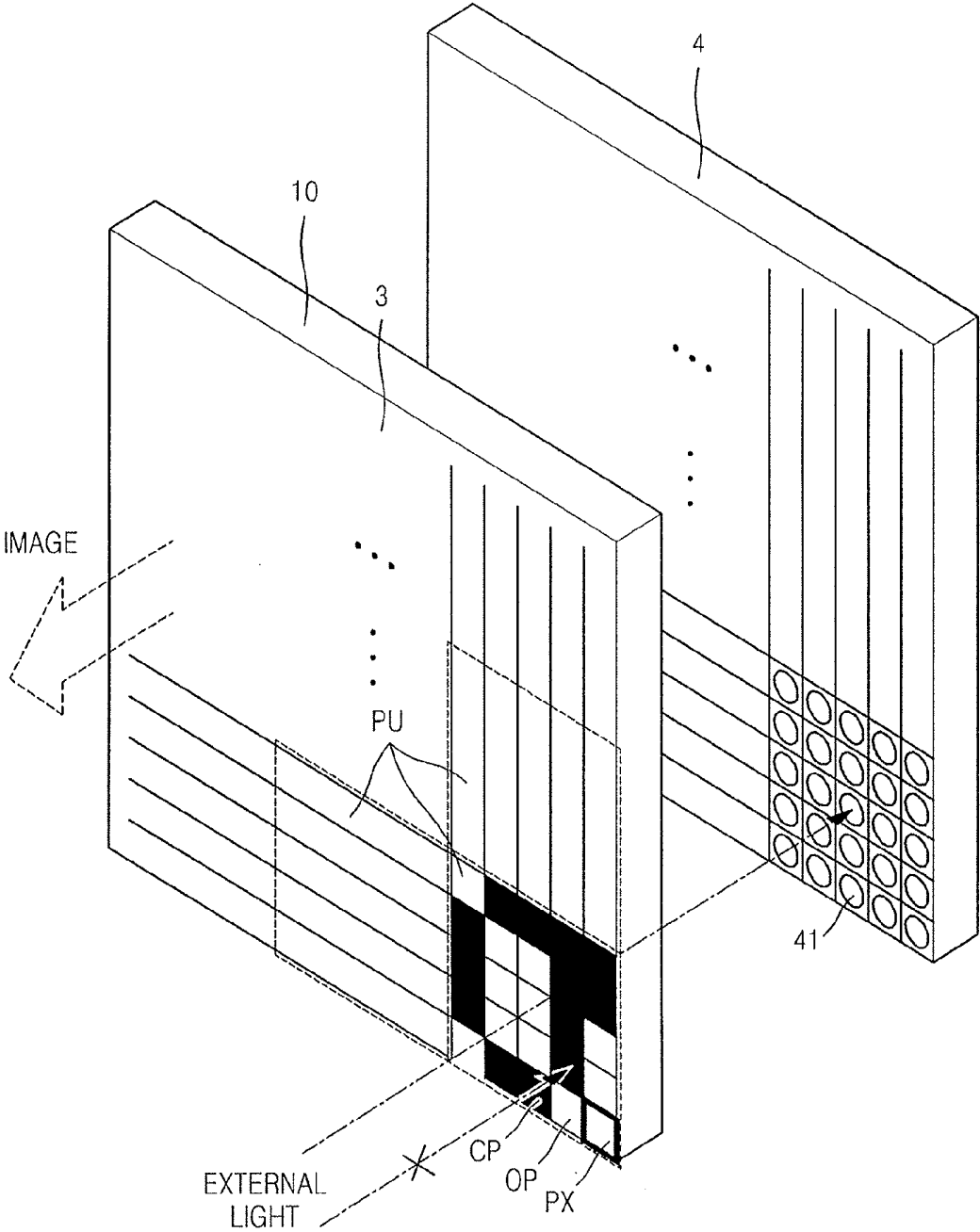

FIG. 3A

FIG. 3B

FIG. 3C

FIG. 3D

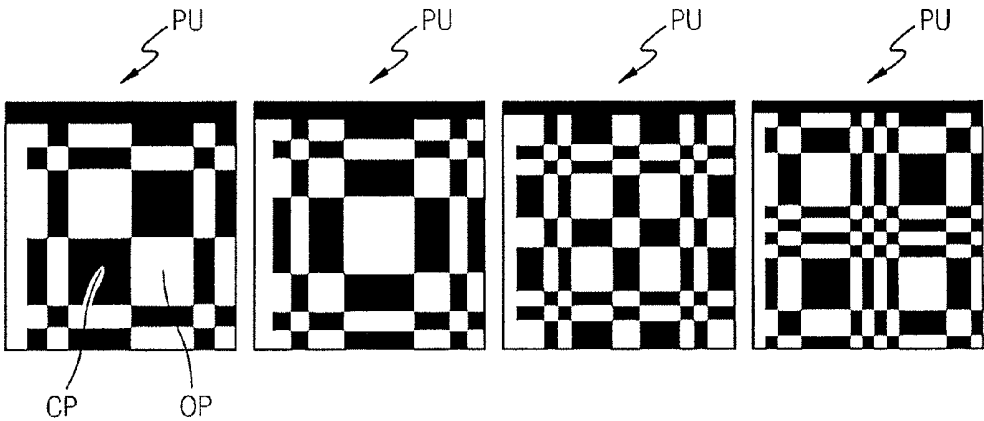

FIG. 4A

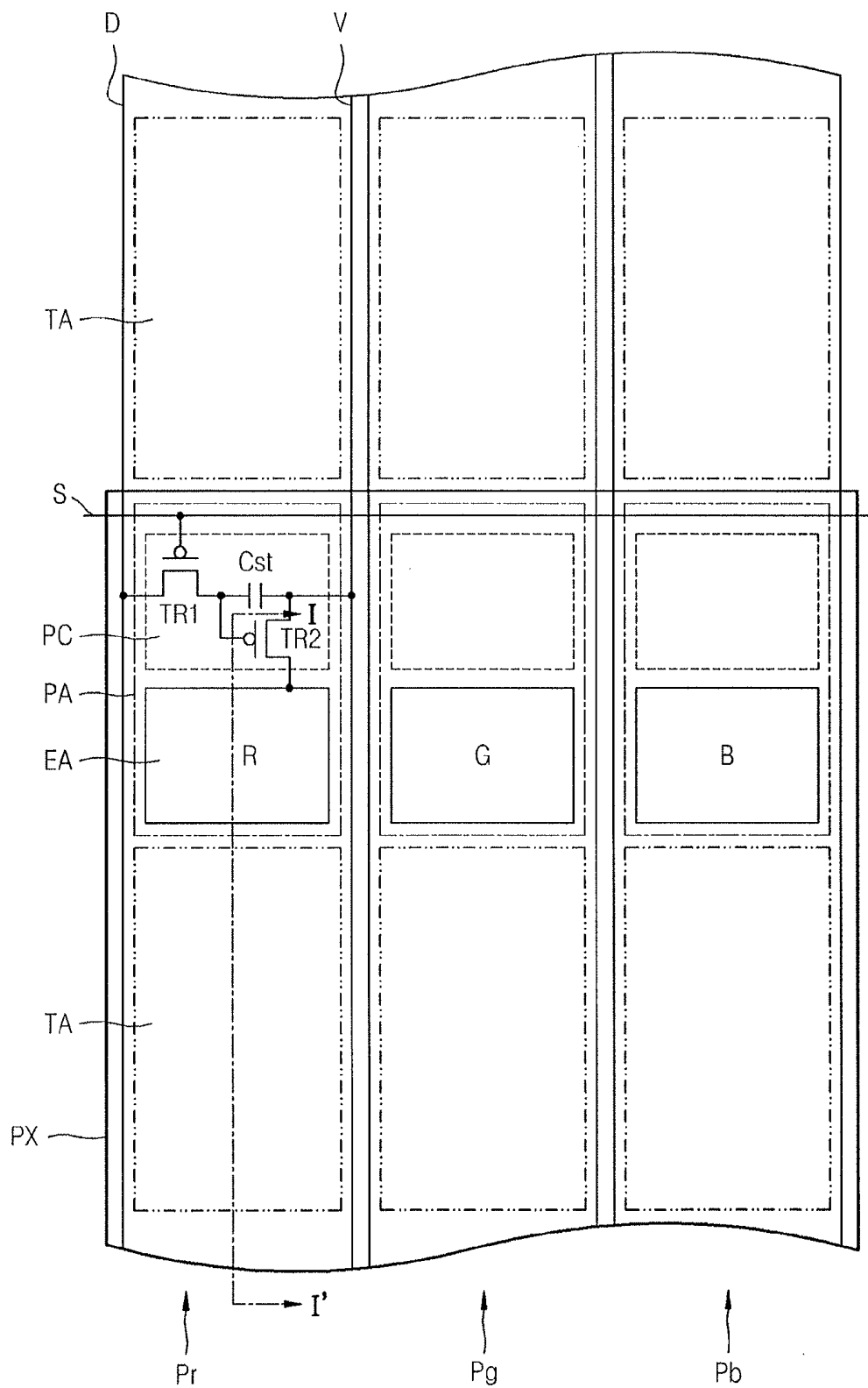

FIG. 4B

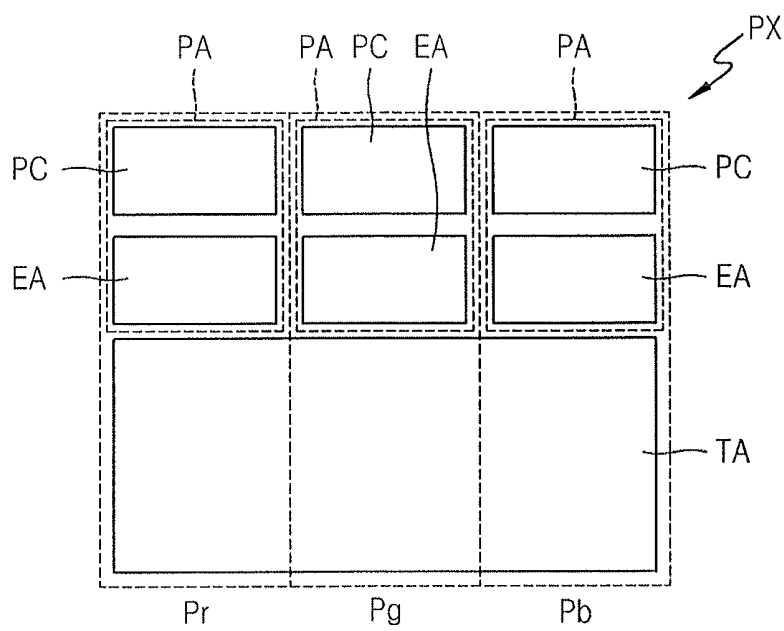

FIG. 5

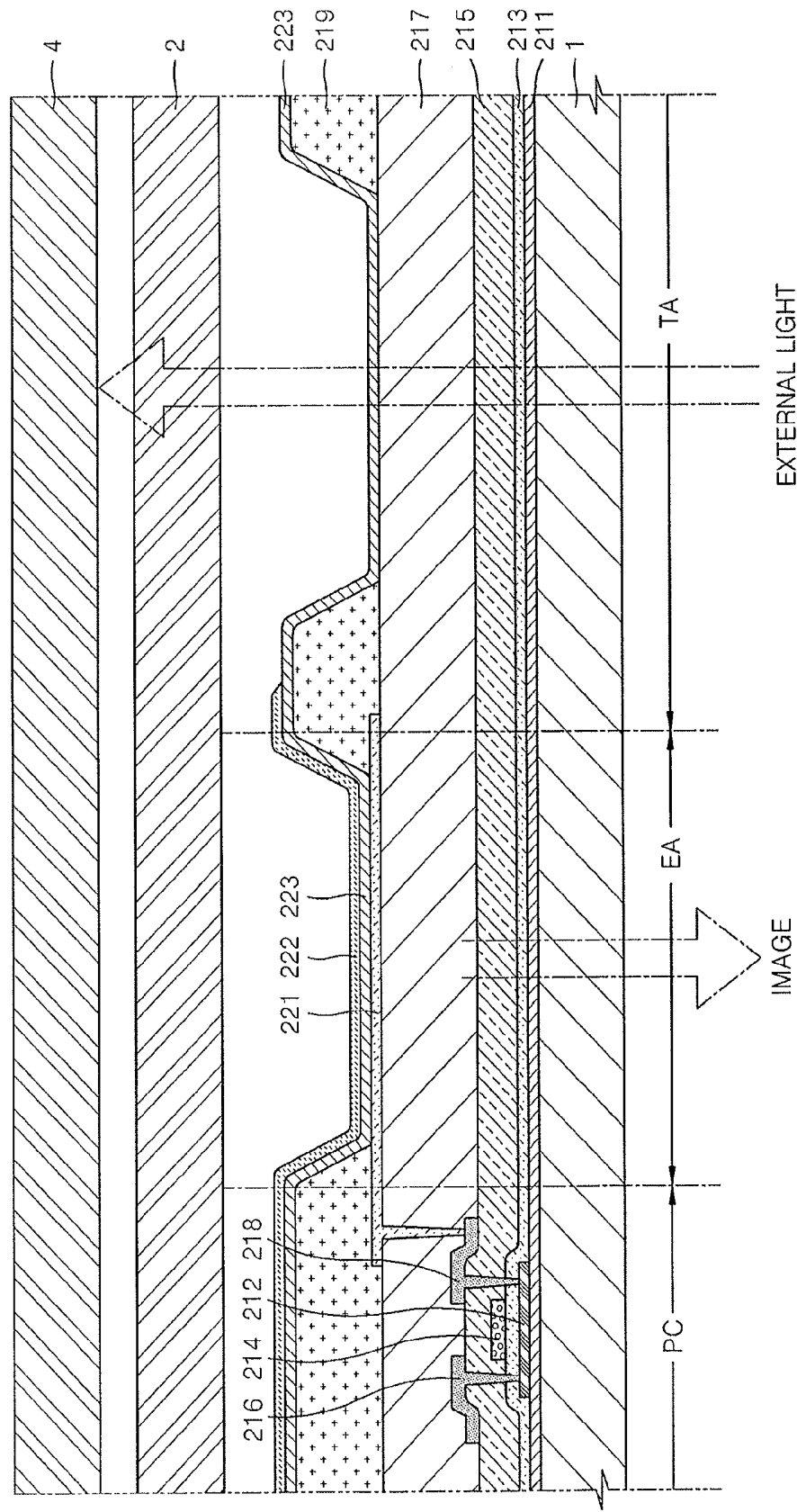

FIG. 6

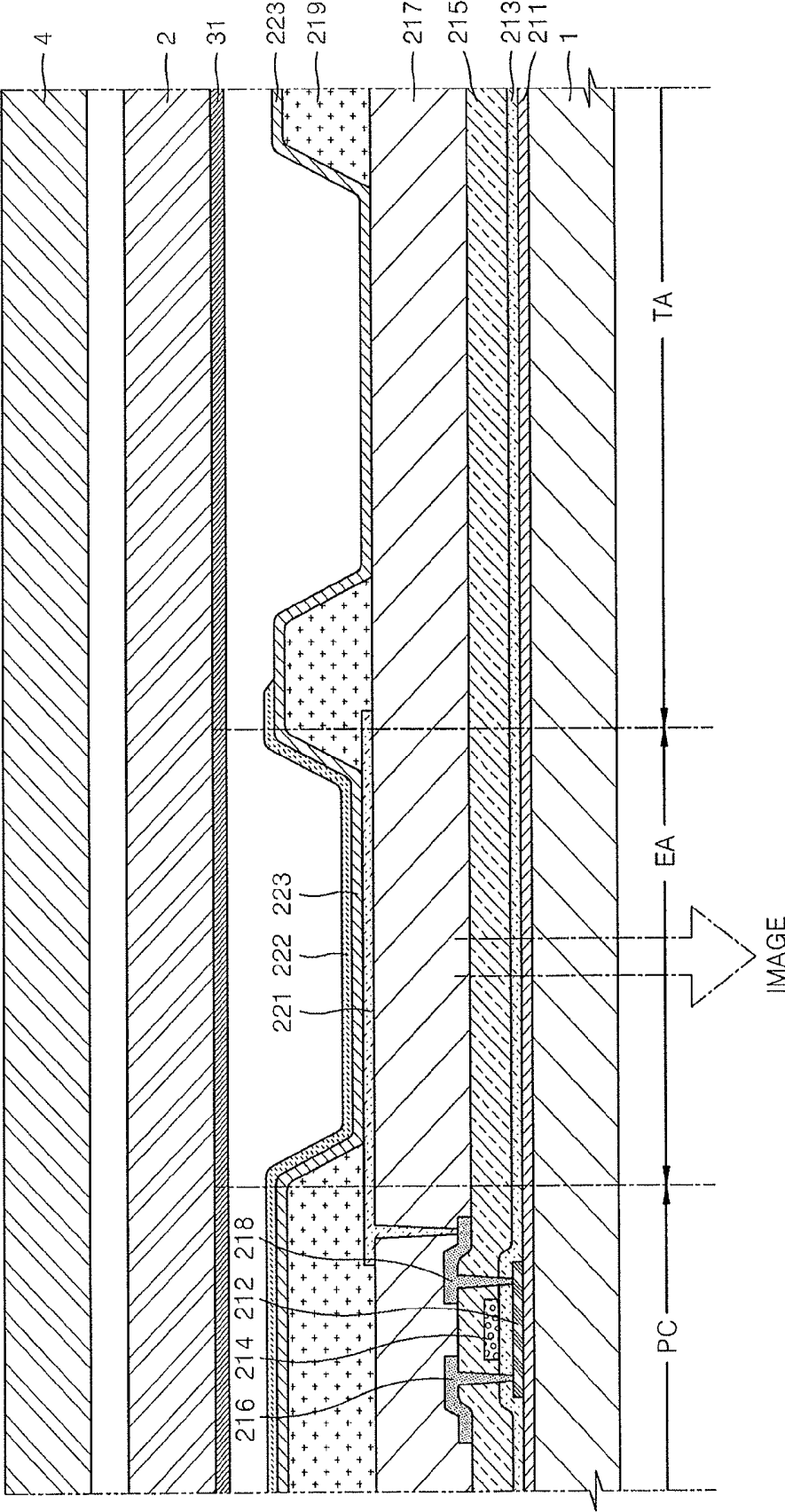



FIG. 7

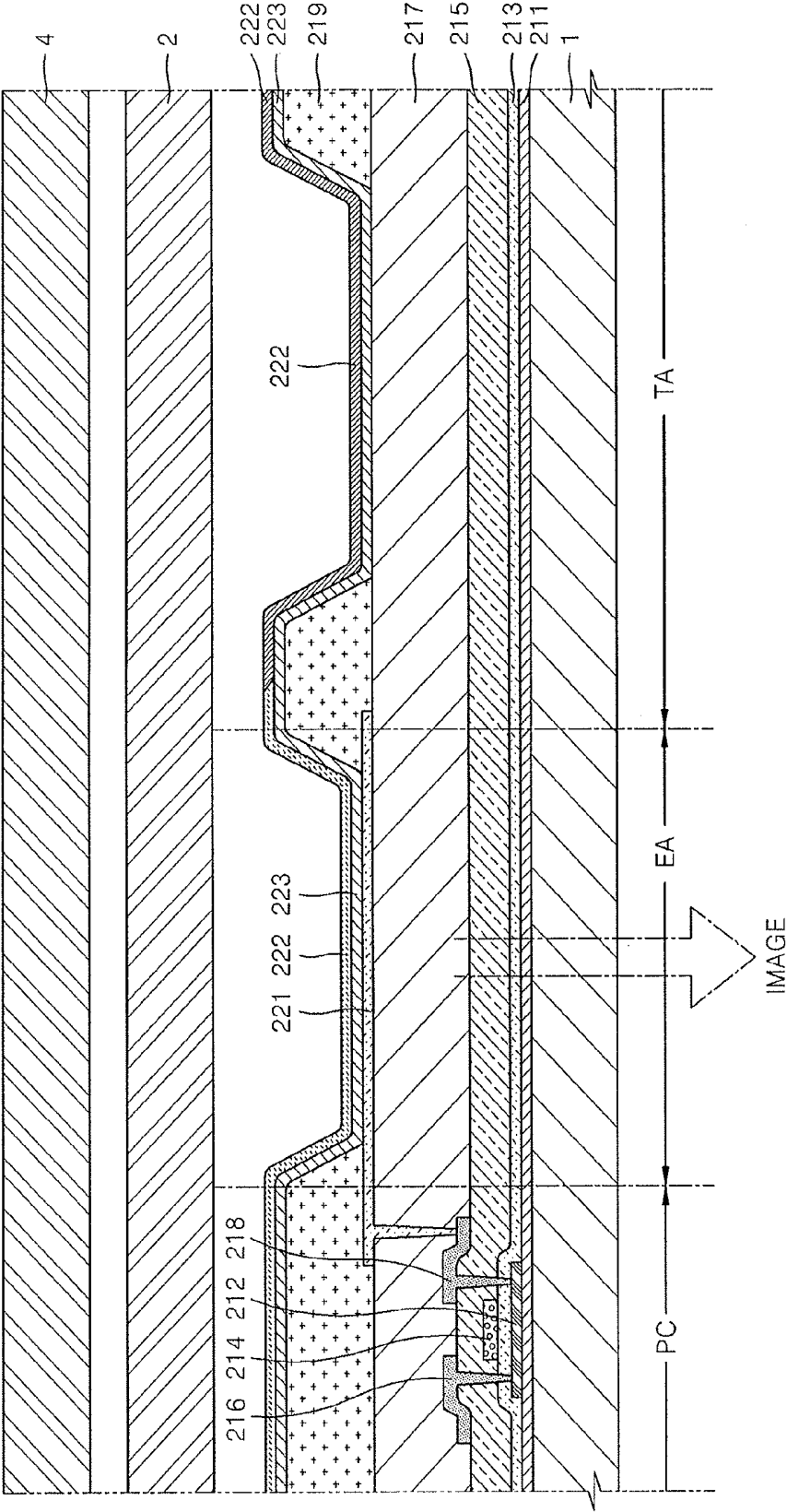



FIG. 9A

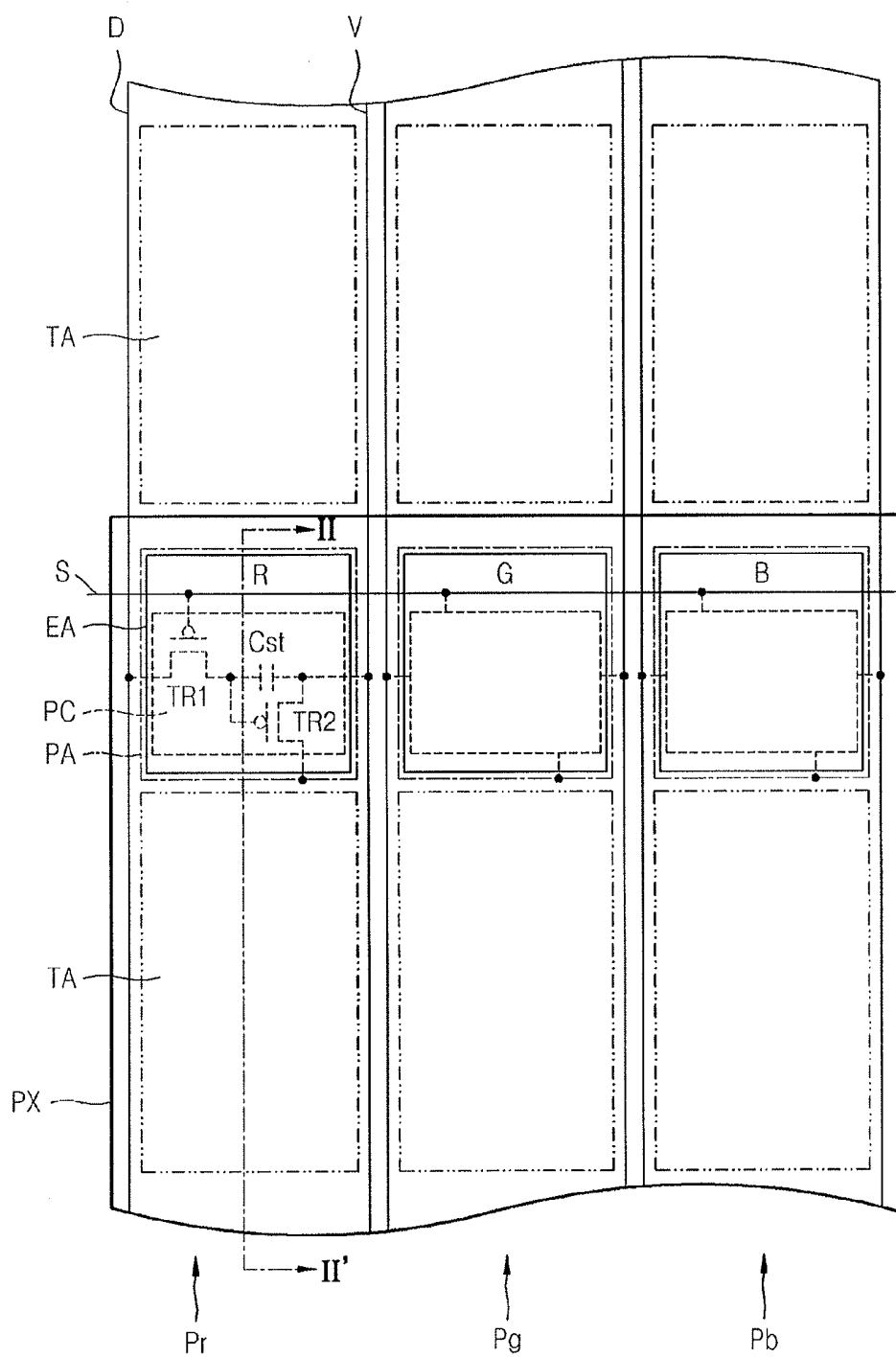

FIG. 9B

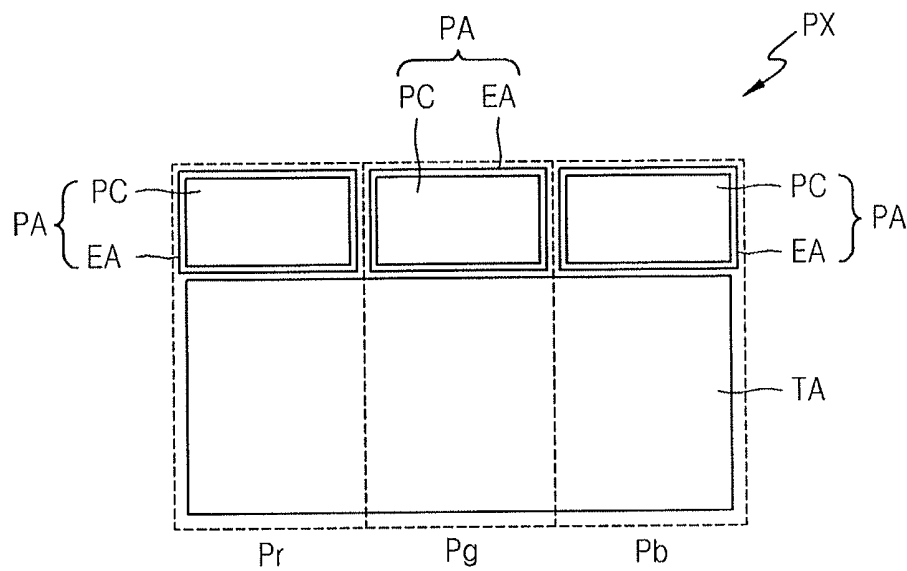

FIG. 10

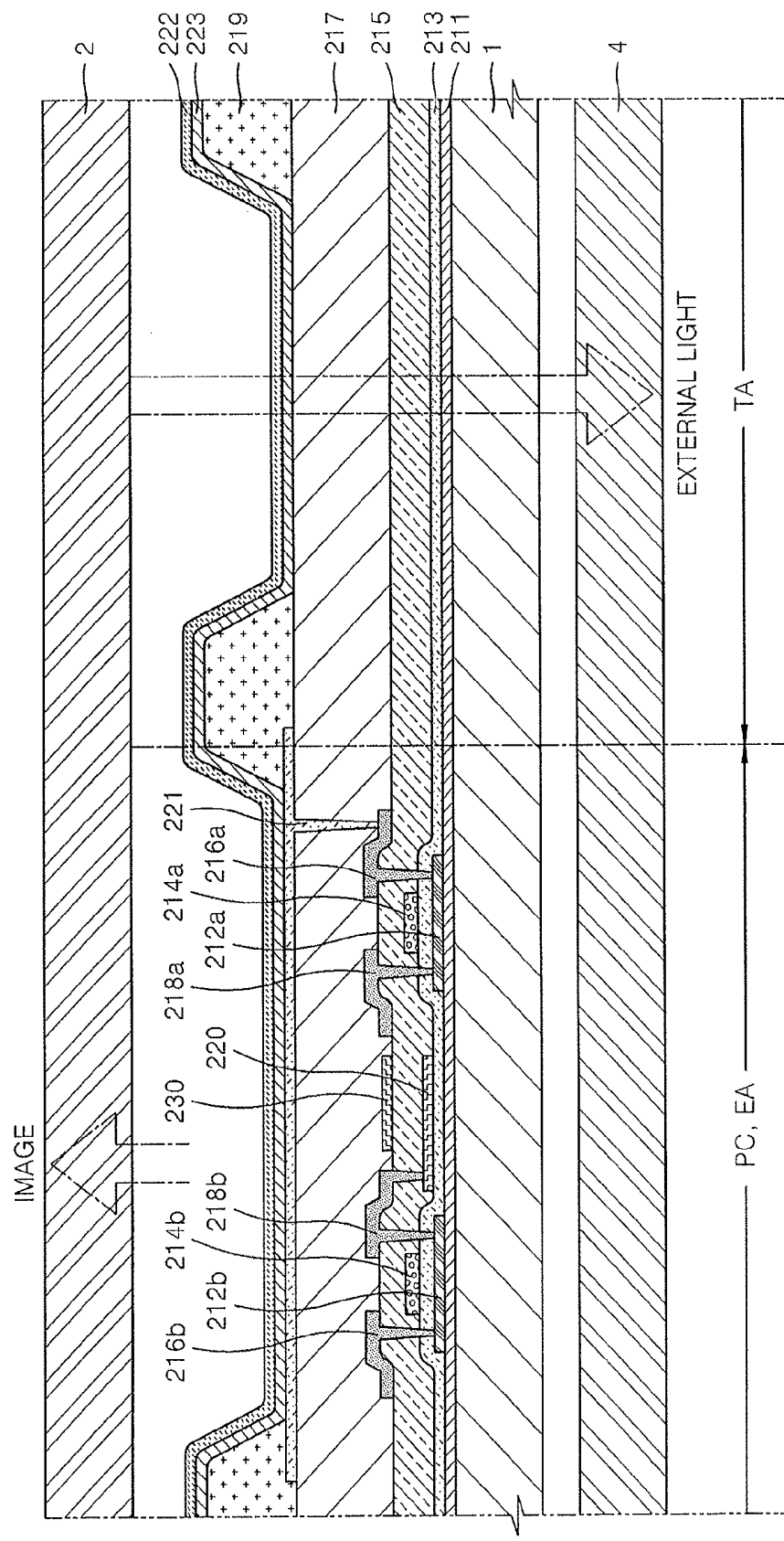
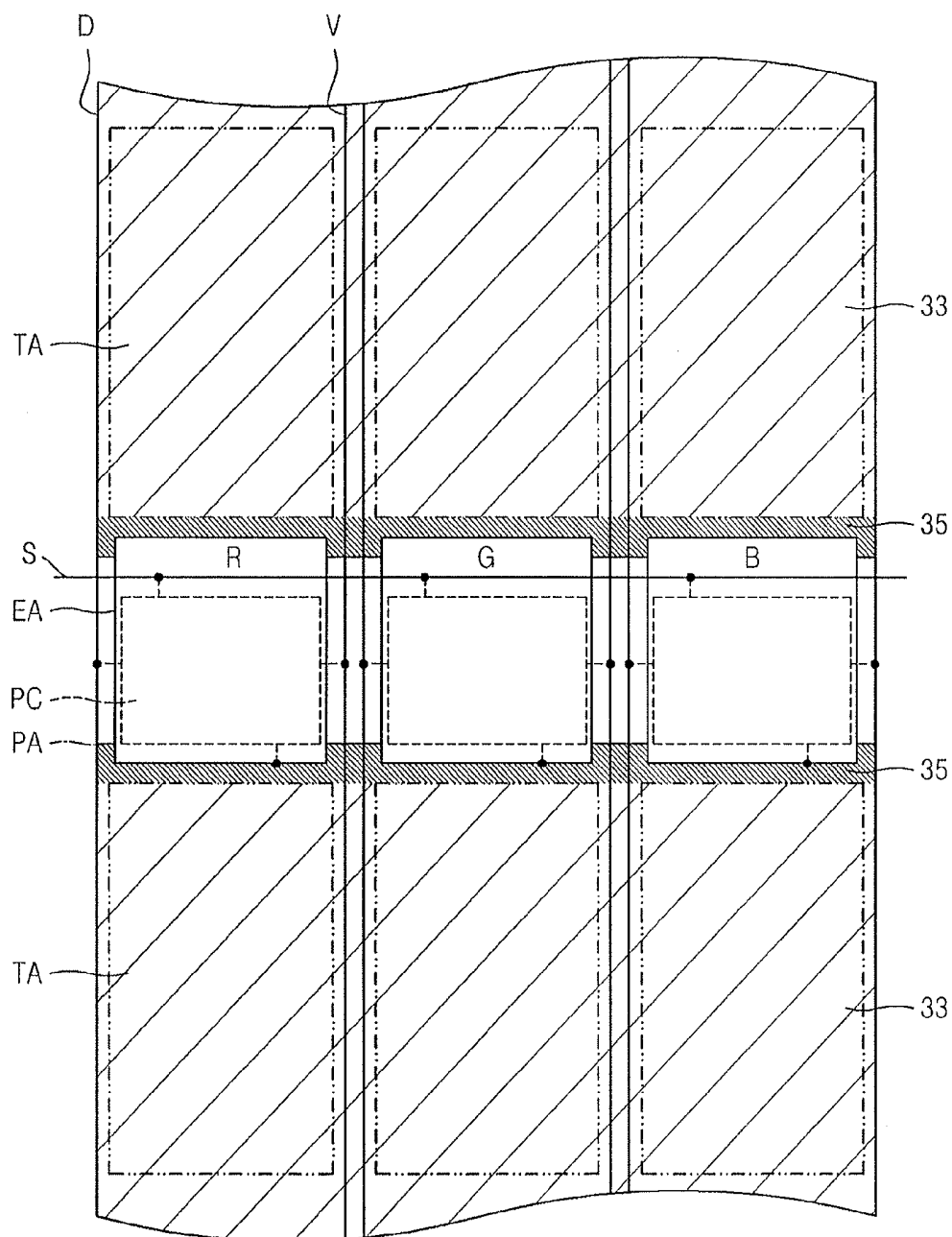



FIG. 12



## ORGANIC LIGHT-EMITTING DISPLAY DEVICE

### CROSS-REFERENCE TO RELATED PATENT APPLICATIONS

[0001] This is a divisional application based on pending application Ser. No. 13/137,977, filed Sep. 22, 2011, the entire contents of which is hereby incorporated by reference.

[0002] This application claims the benefit of Korean Patent Application No. 10-2011-0037348, filed on Apr. 21, 2011, in the Korean Intellectual Property Office, the disclosure of which is incorporated herein in its entirety by reference.

### BACKGROUND

[0003] 1. Field of the Invention

[0004] Embodiments relate to an organic light-emitting display device. More particularly, embodiments relate to an organic light-emitting display device as interactive media.

[0005] 2. Description of the Related Art

[0006] Interactive media is media in which a user and a mechanical device interact with each other. In interactive media, the user and the mechanical device interact with each other according to specific roles. For example, the display device in a display mode may provide an image to a user, and when the user makes a gesture in capture mode, the display device captures and recognizes the gesture. Then, the display device realizes a function corresponding to the gesture.

### SUMMARY

[0007] Embodiments may be directed to an organic light-emitting display device including a first substrate including a pixel area emitting light in a first direction, and a transmittance area that is adjacent to the pixel area and transmits external light; a second substrate facing the first substrate and encapsulating a pixel defined on the first substrate; an optical pattern array formed on the first substrate or the second substrate to correspond to the transmittance area, the optical pattern array being configured to transmit or block external light depending on the transmittance area according to a coded pattern; and a sensor array corresponding to the optical pattern array, the sensory array being arranged in a second direction that is opposite to the first direction in which the light is emitted, the sensory array receiving the external light passing through the optical pattern array.

[0008] The organic light-emitting display device may further include a pixel circuit unit on the first substrate, including one or more thin film transistors (TFTs), and positioned in the pixel area; a first insulating layer covering at least the pixel circuit unit; a first electrode formed on the first insulating layer so as to be electrically connected to the pixel circuit unit, the first electrode being positioned in the pixel area and being adjacent to the pixel circuit unit so as not to overlap with the pixel circuit unit and including a transparent conductive material; a second insulating layer covering at least a portion of the first electrode; a second electrode capable of reflecting light so as to emit light toward the first electrode, the second electrode facing the first electrode and being positioned in the pixel area; and an organic layer interposed between the first electrode and the second electrode and including an emission layer (EML).

[0009] The second insulating layer may include an opening at a position corresponding to the transmittance area.

[0010] The second electrode may include at least one metal of Ag, Mg, Al, Pt, Pd, Au, Ni, Nd, Ir, Cr, Li, Ca, Yb, and alloys thereof.

[0011] The pixel may include a plurality of sub-pixels, and transmittance areas of two adjacent sub-pixels may be connected to each other.

[0012] The optical pattern array may include a transmittance pattern by which the external light is transmitted; and a light-blocking pattern blocking the external light, wherein the light-blocking pattern is implemented when a light-blocking layer is on the second substrate corresponding to the transmittance area.

[0013] The sensor array may be formed on side portions of the second substrate and may receive the external light passing through the transmittance pattern of the optical pattern array.

[0014] The light-blocking layer may include at least one metal of Ag, Mg, Al, Pt, Pd, Au, Ni, Nd, Ir, Cr, Li, Ca, Mo, and alloys thereof or may include a black matrix material.

[0015] The optical pattern array may include a transmittance pattern by which the external light is transmitted; and a light-blocking pattern blocking the external light, wherein the light-blocking pattern is implemented when the second electrode capable of reflecting light is also formed in the transmittance area.

[0016] The organic light-emitting display device may further include a pixel circuit unit on the first substrate, including one or more TFTs, and positioned in the pixel area; a first insulating layer covering at least the pixel circuit unit; a first electrode on the first insulating layer so as to be electrically connected to the pixel circuit unit, the first electrode being positioned in the pixel area and overlapping with the pixel circuit unit so as to cover the pixel circuit unit, the first electrode including a reflective layer that is capable of reflecting light and including a conductive material; a second insulating layer covering at least a portion of the first electrode; a second electrode capable of transmitting light so as to emit light in an opposite direction in which the first electrode reflects light, the second electrode facing the first electrode; and an organic layer interposed between the first electrode and the second electrode and including an EML.

[0017] The second insulating layer may include an opening at a position corresponding to the transmittance area. The reflective layer may include at least one metal of Ag, Mg, Al, Pt, Pd, Au, Ni, Nd, Ir, Cr, Li, Ca, Mo, and alloys thereof.

[0018] The pixel may include the transmittance area, and a plurality of the pixel areas that are separate from each other by having the transmittance area there between.

[0019] The optical pattern array may include a transmittance pattern by which the external light is transmitted; and a light-blocking pattern blocking the external light, wherein the light-blocking pattern is implemented when a light-blocking layer capable of blocking light is on an insulating layer formed in the transmittance area.

[0020] The sensor array may be on side portions of the first substrate and receives the external light passing through the transmittance pattern of the optical pattern array.

[0021] The light-blocking layer may include at least one metal of Ag, Mg, Al, Pt, Pd, Au, Ni, Nd, Ir, Cr, Li, Ca, Mo, and alloys thereof or may include a black matrix material.



## BRIEF DESCRIPTION OF THE DRAWINGS

[0022] The above and other features will become more apparent by describing in detail exemplary embodiments thereof with reference to the attached drawings in which:

[0023] FIG. 1 is a cross-sectional view illustrating a portion of an organic light-emitting display device according to an embodiment;

[0024] FIG. 2 is a perspective view illustrating the organic light-emitting display device of FIG. 1;

[0025] FIG. 3A through 3D illustrates various optical pattern units included in an optical pattern array;

[0026] FIGS. 4A and 4B are diagrams illustrating configurations of a pixel of the organic light-emitting display device, according to an embodiment;

[0027] FIGS. 5 through 7 are cross-sectional views of the organic light-emitting display device of FIG. 4A, taken along a line I-I';

[0028] FIG. 8 is a plane view of a light-blocking pattern of FIG. 7;

[0029] FIGS. 9A and 9B are diagrams illustrating configurations of a pixel of an organic light-emitting display device, according to another embodiment;

[0030] FIGS. 10 and 11 are cross-sectional views of the organic light-emitting display device of FIG. 9A, taken along a line II-II'; and

[0031] FIG. 12 illustrates a plane view of the organic light-emitting display device of FIG. 11.

## DETAILED DESCRIPTION

[0032] Example embodiments will now be described more fully hereinafter with reference to the accompanying drawings; however, they may be embodied in different forms and should not be construed as limited to the embodiments set forth herein.

[0033] While such terms as "first," "second," etc., may be used to describe various components, such components must not be limited to the above terms. The above terms are used only to distinguish one component from another.

[0034] The terms used in the present specification are merely used to describe particular embodiments, and are not intended to limit present embodiments. An expression used in the singular encompasses the expression in the plural, unless it has a clearly different meaning in the context. In the present specification, it is to be understood that the terms such as "including" or "having," etc., are intended to indicate the existence of the features, numbers, steps, actions, components, parts, or combinations thereof disclosed in the specification, and are not intended to preclude the possibility that one or more other features, numbers, steps, actions, components, parts, or combinations thereof may exist or may be added.

[0035] FIG. 1 is a cross-sectional view illustrating a portion of an organic light-emitting display device according to an embodiment.

[0036] Referring to FIG. 1, the organic light-emitting display device includes a panel 10 that includes a first substrate 1 having a pixel area PA for realizing an image in a first direction and a transmittance area TA via which external light is transmitted, and a second substrate 2 encapsulating the first substrate 1.

[0037] In the organic light-emitting display device, the external light passes through the first substrate 1 and the

second substrate 2 and then is received by a sensor array 4 positioned in an opposite side of the first direction in which the image is realized.

[0038] A user may view the image realized on the organic light-emitting display device in the first direction, and when the user makes a gesture 5, the sensor array 4 may capture the gesture 5 of the user, which is projected after passing through the panel 10.

[0039] The panel 10 includes a coded optical pattern array 3. The optical pattern array 3 may be formed on the first substrate 1 or the second substrate 2. In FIG. 1, for convenience, the optical pattern array 3 is illustrated between the first substrate 1 and the second substrate 2. The optical pattern array 3 forms a coded pattern by allowing a predetermined transmittance area TA to be blocked or not to be blocked.

[0040] The sensor array 4 may capture the gesture 5 of the user via the optical pattern array 3 having the coded pattern, and may extract three-dimensional (3D) information by analyzing captured images using software.

[0041] FIG. 2 is a perspective view illustrating the organic light-emitting display device of FIG. 1. In FIG. 2, in order to particularly describe an optical pattern unit PU, the optical pattern unit PU is illustrated on a top surface of the panel 10 so as to be clearly shown.

[0042] Referring to FIG. 2, the panel 10 of the organic light-emitting display device is partitioned into a plurality of pixels PX, and the optical pattern array 3 is formed to have an optical pattern unit PU having a specific pattern with respect to a group of pixels PX. Hence, the optical pattern unit PU having the specific pattern is repeatedly and continuously formed in the panel 10, and thus forms the optical pattern array 3.

[0043] An optical pattern is divided into a transmittance pattern OP via which external light is transmitted and a light-blocking pattern CP for blocking the external light. The present embodiment is characterized in that the transmittance pattern OP and the light-blocking pattern CP are realized by directly disposing light-blocking films 31 and 33 on the organic light-emitting display device. Thus, it is not necessary to display a separate optical mask pattern and to have a backlight, so that the organic light-emitting display device may be large and slim. A method of realizing the transmittance pattern OP and the light-blocking pattern CP will be described in detail at a later time.

[0044] The sensor array 4 is formed of sensors 41 each corresponding to a pixel PX and an optical pattern. Here, each sensor 41 may be an imaging device capable of capturing an image by receiving light. For example, each sensor 41 may be a charge-coupled device (CCD) sensor or a complementary metal-oxide-semiconductor (CMOS) sensor.

[0045] The sensor array 4 receives incident light by using the optical pattern array 3 as an optical mask. For example, the sensor 41 corresponding to the transmittance pattern OP may capture an image by receiving light, but the sensors 41 corresponding to the light-blocking pattern CP do not receive incident light, so that the sensors 41 corresponding to the light-blocking pattern CP may not capture an image or may obtain only a black image.

[0046] The sensor array 4 may capture images according to optical patterns, respectively. A signal processing unit (not shown) may obtain a 3D image by processing the images obtained from the sensor array 4.

[0047] FIG. 3 illustrates various optical pattern units PU included in the optical pattern array 3.

[0048] Referring to FIG. 3, a case (a) indicates an optical pattern unit PU with respect to a group of  $11 \times 11$  pixels PX in total. A case (b) indicates an optical pattern unit PU with respect to a group of  $13 \times 13$  pixels PX in total, and a case (c) indicates an optical pattern unit PU with respect to a group of  $17 \times 17$  pixels PX in total. A case (d) indicates an optical pattern unit PU with respect to a group of  $19 \times 19$  pixels PX in total.

[0049] In FIG. 3, a black portion indicates a light-blocking pattern CP that blocks light entering the sensor array 4, and a white portion indicates a transmittance pattern OP that does not block light entering the sensor array 4.

[0050] According to the present embodiment, as described in FIG. 2, the optical pattern units PU of FIG. 3 are repeatedly formed in the panel 10, thereby forming the optical pattern array 3. Various optical pattern shapes are coded to allow the signal processing unit (not shown) to easily obtain 3D information, and shapes and functions of the coded optical patterns are well known according to the related art.

[0051] Hereinafter, how the transmittance pattern OP and the light-blocking pattern CP of the optical pattern array 3 are realized in the organic light-emitting display device will be described in detail.

[0052] FIG. 4A is a diagram illustrating a configuration of a pixel PX of the organic light-emitting display device, according to an embodiment. FIG. 4B is a diagram illustrating a configuration of a pixel PX of an organic light-emitting display device, according to another embodiment.

[0053] Referring to FIGS. 4A and 4B, the pixel PX formed on the first substrate 1 includes a transmittance area TA via which external light is transmitted, and a pixel area PA that is adjacent to the transmittance area TA. In more detail, the pixel PX may include a plurality of sub-pixels Pr, Pg, and Pb. Each of the sub-pixels Pr, Pg, and Pb includes the pixel area PA and the transmittance area TA, and the pixel areas PA of the sub-pixels Pr, Pg, and Pb included in the pixel PX emit different types of light. For example, the pixel area PA of the first sub-pixel Pr emits red light R, the pixel area PA of the second sub-pixel Pg emits green light G, and the pixel area PA of the third sub-pixel Pb emits blue light B.

[0054] As illustrated in FIG. 4A, according to the present embodiment, the transmittance area TA may be independently formed for each of the sub-pixels Pr, Pg, and Pb. However, according to another embodiment, as illustrated in FIG. 4B, the transmittance area TA may be commonly formed while extending over the sub-pixels Pr, Pg, and Pb. That is, the pixel PX may include the transmittance area TA, and the pixel areas PA that are separate from each other by having the transmittance area TA therebetween.

[0055] The pixel area PA includes a pixel circuit unit PC including one or more thin film transistors (TFTs) TR1 and TR2, and a plurality of conductive lines including a scan line S, a data line D, and a VDD line V are electrically connected to the pixel circuit unit PC. Although not illustrated in FIGS. 4A and 4B, according to a configuration of the pixel circuit unit PC, in addition to the scan line S, the data line D, and the VDD line V that delivers a driving power, various conductive lines may be further arranged.

[0056] The pixel circuit unit PC includes the first TFT TR1 connected to the scan line S and the data line D, the second TFT TR2 connected to the first TFT TR1 and the VDD line V, and a capacitor Cst connected to the first TFT TR1 and the second TFT TR2. Here, the first TFT TR1 becomes a switching transistor, and the second TFT TR2 becomes a driving

transistor. The second TFT TR2 is electrically connected to a first electrode 221. The first TFT TR1 and the second TFT TR2 may be formed as a P-type or an N-type. The number of TFTs and capacitors is not limited to the aforementioned number according to the present embodiment, and according to other configurations of the pixel circuit unit PC, two or more TFTs and one or more capacitors may be combined.

[0057] The pixel area PA includes a light-emission unit EA emitting light, and the light-emission unit EA is electrically connected to the pixel circuit unit PC. Referring to FIGS. 4A and 4B, the light-emission unit EA does not overlap with the pixel circuit unit PC but is adjacent to it.

[0058] According to the present embodiment, in order to implement interactive media, the optical pattern array 3 is formed to correspond to the transmittance area TA. Hereinafter, a case in which a transmittance pattern OP is formed to correspond to a transmittance area TA will be described in detail with reference to FIG. 5. A case in which a light-blocking pattern CP is formed to correspond to a transmittance area TA will be described in detail with reference to FIGS. 6 through 8.

[0059] FIGS. 5 through 7 are cross-sectional views of the organic light-emitting display device of FIG. 4A, taken along a line I-I'. FIGS. 5 through 7 also illustrate configurations of a second substrate 2 and a sensor array 4 that are not illustrated in FIGS. 4A and 4B.

[0060] FIG. 5 illustrates a case in which the transmittance pattern OP is formed to correspond to the transmittance area TA, according to an embodiment.

[0061] Referring to FIG. 5, the second TFT TR2 is formed on a first substrate 1 and has a structure in which a buffer layer 211 is formed to prevent penetration of moisture, and an active layer 212, a gate insulating layer 213, a gate electrode 214, an interlayer insulating layer 215, and source and drain electrodes 216 and 218 are sequentially formed on the buffer layer 211. The second TFT TR2 is included in the pixel circuit unit PC. Next, a passivation layer 217 that is an insulating layer is formed to completely cover the pixel circuit unit PC and the transmittance area TA.

[0062] A first electrode 221 that is transparent and that is electrically connected to the second TFT TR2 of the pixel circuit unit PC is formed on the passivation layer 217. In particular, the first electrode 221 is included in the light-emission unit EA. Here, the first electrode 221 includes a transparent conductive material. For example, the first electrode 221 may be formed as ITO, IZO, ZnO, or  $\text{In}_2\text{O}_3$ , which has a high work function. In this case, the first electrode 221 functions as an anode.

[0063] Reference numeral 219 of FIG. 5 is a pixel defining layer (PDL) 219 that covers side portions of the first electrode 221 and exposes a center portion of the first electrode 221. The PDL 219 may cover the pixel area PA. In this regard, it is not necessary for the PDL 219 to completely cover the pixel area PA. Thus, it is sufficient for the PDL 219 to cover at least a portion of the pixel area PA, i.e., side portions of the pixel area PA.

[0064] A second electrode 222 faces the first electrode 221 and is formed in the light-emission unit EA. The second electrode 222 is formed of a material capable of reflecting light so as to emit the light toward the first electrode 221. For example, the second electrode 222 may include at least one metal of Ag, Mg, Al, Pt, Pd, Au, Ni, Nd, Ir, Cr, Li, Ca, Yb, and alloys thereof. In this case, the second electrode 222 functions as a cathode.

**[0065]** The second electrode **222** may extend over the entire pixel area PA so as to cover both the light-emission unit EA and the pixel circuit unit PC. However, the second electrode **222** is not formed in the transmittance area TA. By doing so, external light may be transmitted to the sensor array **4** from the transmittance area TA. Due to the aforementioned configurations of the first electrode **221** and the second electrode **222**, in the organic light-emitting display device of FIG. 5, light is emitted to the first electrode **221** that is toward a bottom side.

**[0066]** An organic layer **223** is interposed between the first electrode **221** and the second electrode **222**, and includes an emission layer (EML). The organic layer **223** may be formed as a small-molecule organic layer or a polymer organic layer. When the organic layer **223** is formed as the small-molecule organic layer, the organic layer **223** may have a structure in which a Hole Injection Layer (HIL), a Hole Transport Layer (HTL), an EML, an Electron Transport Layer (ETL), an Electron Injection Layer (EIL) or the like are singularly or multiply stacked, and may be formed by using one of various organic materials including copper phthalocyanine (CuPc), N,N'-Di(naphthalene-1-yl)-N,N'-diphenyl-benzidine (NPB), tris-8-hydroxyquinoline aluminum (Alq<sub>3</sub>), etc. The small-molecule organic layer may be formed by using a vacuum deposition method.

**[0067]** The second substrate **2** is formed above the first substrate **1** so as to encapsulate the pixel area PA and the transmittance area TA. Here, the second substrate **2** may be formed of a transparent material, and may have a substrate shape or a sheet shape.

**[0068]** The sensor array **4** is disposed near to the second substrate **2**. That is, the sensor array **4** is disposed at a top side that is away from the occurrence of light emission.

**[0069]** Referring to the pixel PX of FIG. 5, in order to allow the sensor array **4** corresponding to the transmittance area TA of the pixel PX to receive external light, a structure that blocks transmission of the external light is not formed in the transmittance area TA. In other words, the optical pattern array **3** corresponding to the pixel PX of FIG. 5 corresponds to the transmittance pattern OP.

**[0070]** On the other hand, FIG. 6 illustrates a case in which the light-blocking pattern CP is formed to correspond to the transmittance area TA, according to another embodiment.

**[0071]** Unlike the case of FIG. 5, FIG. 6 is characterized such that a light-blocking layer **31** is formed on one surface of a second substrate **2**. In the case of FIG. 6, the light-blocking layer **31** is formed on the surface of the second substrate **2** facing a first substrate **1**. However, according to one or more embodiments, the light-blocking layer **31** may be formed on the other surface of the second substrate **2**, which is away from the first substrate **1**. While it is sufficient for the light-blocking layer **31** to cover only the transmittance area TA, it is also possible for the light-blocking layer **31** to be formed in both of the pixel area PA and the transmittance area TA so as to completely cover the pixel PX.

**[0072]** The light-blocking layer **31** may be formed of a material capable of reflecting or blocking light, and for example, the light-blocking layer **31** may include at least one metal of Ag, Mg, Al, Pt, Pd, Au, Ni, Nd, Ir, Cr, Li, Ca, Mo, and alloys thereof or may include a black matrix material.

**[0073]** According to the present embodiment, the optical pattern array **3** corresponding to the pixel PX of FIG. 6 includes the light-blocking layer **31** so that external light is not transmitted via the transmittance area TA. Thus, the opti-

cal pattern array **3** is the light-blocking pattern CP that cannot deliver light to the sensor array **4** corresponding to the pixel PX.

**[0074]** FIG. 7 is a cross-sectional view illustrating another example of the light-blocking pattern CP of FIGS. 4A and 4B which is different from that of FIG. 6, according to another embodiment. FIG. 8 is a plane view of the light-blocking pattern CP of FIG. 7.

**[0075]** Unlike the embodiment of FIG. 6, the present embodiment of FIG. 7 is characterized in that the light-blocking layer **31** is not formed on a second substrate **2**, but instead, a second electrode **222** capable of reflecting light extends over a transmittance area TA. In other words, as illustrated in FIG. 8, the second electrode **222** is formed to completely cover a pixel area PA and the transmittance area TA.

**[0076]** According to the present embodiment, the optical pattern array **3** that corresponds to the pixel PX of FIGS. 7 and 8 cannot transmit external light to the sensor array **4**. Thus, similar to the embodiment of FIG. 6, the optical pattern array **3** of FIG. 7 is the light-blocking pattern CP that cannot deliver light to the sensor array **4** corresponding to the pixel PX.

**[0077]** FIG. 9A is a diagram illustrating a configuration of a pixel PX of an organic light-emitting display device, according to another embodiment. FIG. 9B is a diagram illustrating a configuration of a pixel PX of an organic light-emitting display device, according to another embodiment.

**[0078]** Referring to FIG. 9A, the pixel PX formed on a first substrate **1** includes a transmittance area TA that transmits external light, and a pixel area PA that is adjacent to the transmittance area TA. Here, similar to the pixel area PA, the transmittance area TA may be independently formed for each of a plurality of sub-pixels Pr, Pg, and Pb. However, referring to the other embodiment of FIG. 9B, the transmittance area TA may be commonly formed while extending over the sub-pixels Pr, Pg, and Pb. The pixel areas PA of the sub-pixels Pr, Pg, and Pb included in the pixel PX emit different types of light. For example, the pixel area PA of the first sub-pixel Pr emits red light R, the pixel area PA of the second sub-pixel Pg emits green light G, and the pixel area PA of the third sub-pixel Pb emits blue light B.

**[0079]** The pixel area PA includes a pixel circuit unit PC including one or more TFTs TR1 and TR2, and a plurality of conductive lines including a scan line S, a data line D, and a VDD line V are electrically connected to the pixel circuit unit PC. Although not illustrated in FIGS. 9A and 9B, according to a configuration of the pixel circuit unit PC, in addition to the scan line S, the data line D, and the VDD line V that delivers a driving power, various conductive lines may be further arranged.

**[0080]** The pixel circuit unit PC includes the first TFT TR1 connected to the scan line S and the data line D, the second TFT TR2 connected to the first TFT TR1 and the VDD line V, and a capacitor Cst connected to the first TFT TR1 and the second TFT TR2. Here, the first TFT TR1 becomes a switching transistor, and the second TFT TR2 becomes a driving transistor. The second TFT TR2 is electrically connected to a first electrode **221**. The first TFT TR1 and the second TFT TR2 may be formed as a P-type or an N-type. The number of TFTs and capacitors is not limited to the aforementioned number according to the present embodiment, and according to other configurations of the pixel circuit unit PC, two or more TFTs and one or more capacitors may be combined.

**[0081]** The pixel area PA includes a light-emission unit EA emitting light, and the light-emission unit EA is electrically

connected to the pixel circuit unit PC. Unlike the embodiments of FIGS. 4A and 4B, referring to the embodiments of FIGS. 9A and 9B, the light-emission unit EA overlaps with the pixel circuit unit PC so as to cover the pixel circuit unit PC.

[0082] According to the present embodiment, in order to implement interactive media, an optical pattern array 3 is formed to correspond to the transmittance area TA. Hereinafter, a case in which a transmittance pattern OP is formed to correspond to a transmittance area TA will be described in detail with reference to FIG. 10, and a case in which a light-blocking pattern CP is formed to correspond to a transmittance area TA will be described in detail with reference to FIGS. 11 and 12.

[0083] FIGS. 10 and 11 are cross-sectional views of the organic light-emitting display device of FIG. 9A, taken along a line II-II'. FIGS. 10 and 11 also illustrate configurations of a second substrate 2 and a sensor array 4 that are not illustrated in FIGS. 9A and 9B.

[0084] First, FIG. 10 illustrates a case in which the transmittance pattern OP is formed to correspond to the transmittance area TA.

[0085] Referring to FIG. 10, the first and second TFTs TR1 and TR2 are formed on a first substrate 1 and have structures in which a buffer layer 211 is formed to prevent penetration of moisture, and an active layer 212, a gate insulating layer 213, a gate electrode 214, an interlayer insulating layer 215, and source and drain electrodes 216 and 218 are sequentially formed on the buffer layer 211. Also, FIG. 10 further illustrates the capacitor Cst formed on the gate insulating layer 213. Here, the capacitor Cst includes a lower electrode 220, an upper electrode 230, and an interlayer insulating 215 interposed between the lower electrode 220 and the upper electrode 230. The first and second TFTs TR1 and TR2, and the capacitor Cst are included in the pixel circuit unit PC. Next, a passivation layer 217 that is an insulating layer is formed to completely cover the pixel circuit unit PC and the transmittance area TA.

[0086] A first electrode 221 that is electrically connected to the second TFT TR2 of the pixel circuit unit PC and that includes a reflective layer capable of reflecting light is formed on the passivation layer 217. Here, the first electrode 221 has a multi-layer structure of a transparent conductive layer and the reflective layer. Here, the transparent conductive layer may be formed of ITO, IZO, ZnO, or  $\text{In}_2\text{O}_3$ , which has a high work function. Here, the reflective layer may include at least one metal of Ag, Mg, Al, Pt, Pd, Au, Ni, Nd, Ir, Cr, Li, Ca, Mo, and alloys thereof. The first electrode 221 may be formed only in the light-emission unit EA. In this case, the first electrode 221 functions as an anode.

[0087] Reference numeral 219 of FIG. 10 is a PDL 219 that covers side portions of the first electrode 221 and exposes a center portion of the first electrode 221. The PDL 219 may cover the pixel area PA and in this regard, it is not necessary for the PDL 219 to completely cover the pixel area PA. Thus, it is sufficient for the PDL 219 to cover at least a portion of the pixel area PA, i.e., side portions of the pixel area PA.

[0088] A second electrode 222 faces the first electrode 221 and is formed in the light-emission unit EA. The second electrode 222 is formed to be light-transmitting so as to emit light in a direction of the second electrode 222. For example, the second electrode 222 may be formed of metal having a small work function, e.g., Ag, Mg, Al, Pt, Pd, Au, Ni, Nd, Ir, Cr, Li, Ca, Yb, or alloys thereof. Here, the second electrode 222 may be formed as a thin film having a thickness in the

range of 100 to 300 Å so as to have high transmittance. In this manner, the second electrode 222 is formed as a semi-transmissive and semi-reflective layer to be light-transmitting, so that the organic light-emitting display device is formed as a top-emission organic light-emitting display device. In this case, the second electrode 222 functions as a cathode.

[0089] The second electrode 222 may be formed not only in the pixel area PA but also in the transmittance area TA. According to the present embodiment, the second electrode 222 is formed as the thin film, so that, although the second electrode 222 is formed in the transmittance area TA, external light may pass through the second electrode 222. Due to the aforementioned configurations of the first electrode 221 and the second electrode 222, in the organic light-emitting display device of FIG. 10, light is emitted to the second electrode 222 that is toward a top side.

[0090] An organic layer 223 is interposed between the first electrode 221 and the second electrode 222, and includes an EML. The organic layer 223 may be formed as a small-molecule organic layer or a polymer organic layer.

[0091] The second substrate 2 is formed to encapsulate the pixel area PA and the transmittance area TA formed on the first substrate 1. Here, the second substrate 2 may be formed of a transparent material, and may have a substrate shape or a sheet shape.

[0092] The sensor array 4 is disposed near to the first substrate 1. That is, the sensor array 4 is disposed at a bottom side that is away from the occurrence of light emission.

[0093] Referring to the pixel PX of FIG. 10, in order to allow the sensor array 4 corresponding to the transmittance area TA of the pixel PX to receive external light, a structure that blocks transmission of the external light is not formed in the transmittance area TA. In other words, the optical pattern array 3 corresponding to the pixel PX of FIG. 5 corresponds to the transmittance pattern OP.

[0094] On the other hand, FIG. 11 illustrates a case in which the light-blocking pattern CP is formed to correspond to the transmittance area TA, according to another embodiment. FIG. 12 illustrates a plane view of the organic light-emitting display device of FIG. 11.

[0095] Unlike the case of FIG. 10, FIG. 11 is characterized such that light-blocking layers 33 and 35 are formed on an insulating layer formed in the transmittance area TA. However, according to one or more embodiments, the light-blocking layers 33 and 35 may be formed on one surface of the first substrate 1 which corresponds to the transmittance area TA, or may be formed on the other surface of the first substrate 1. While it is sufficient for the light-blocking layers 33 and 35 to cover only the transmittance area TA, it is also possible for the light-blocking layers 33 and 35 to be formed in both the pixel area PA and the transmittance area TA so as to completely cover the pixel PX.

[0096] In the organic light-emitting display device of FIG. 11, the first light-blocking layer 33 is formed on the passivation layer 217 corresponding to the transmittance area TA, and the second light-blocking layer 35 is formed on the gate insulating layer 213 corresponding to an area between the transmittance area TA and the pixel area PA. In other words, referring to FIG. 11, the light-blocking layer 33 formed on the same layer as the first electrode 221 cannot completely block external light escaping through a space between the first electrode 221 and the first light-blocking layer 33, and external light escaping through a space between the first light-blocking layer 33 and the first electrode 221 of an adjacent

pixel. Thus, the second light-blocking layer **35** is used. Referring to FIG. **12**, external light cannot pass through the transmittance area TA due to the first and second light-blocking layers **33** and **35**.

**[0097]** The light-blocking layers **33** and **35** may be formed of a material capable of reflecting or blocking light, and for example, the light-blocking layer **31** may include at least one metal of Ag, Mg, Al, Pt, Pd, Au, Ni, Nd, Ir, Cr, Li, Ca, Mo, and alloys thereof or may include a black matrix material.

**[0098]** According to the present embodiment, the optical pattern array **3** corresponding to the pixel PX of FIGS. **11** and **12** includes the light-blocking layers **33** and **35** so that transmittance of external light is partially impossible in the transmittance area TA. Thus, the optical pattern array **3** of FIGS. **11** and **12** is the light-blocking pattern CP that cannot deliver light to the sensor array **4** corresponding to the pixel PX.

**[0099]** In the present embodiment, the insulating layer may be formed of a transparent material so as to increase transmittance of the transmittance area TA. Here, the insulating layer may indicate the passivation layer **217**. However, the one or more embodiments are not limited thereto. Thus, all of the interlayer insulating layer **215**, the gate insulating layer **213**, and the buffer layer **211** may be formed of a transparent material, whereby transmittance of the organic light-emitting display device may be further increased.

**[0100]** In addition, in order to further increase the transmittance of the transmittance area TA and to prevent optical interference due to transparent insulating layers in the transmittance area TA, and color purity deterioration and color change due to the optical interference, an opening may be formed in some of the insulating layers corresponding to the transmittance area TA.

**[0101]** For example, the opening may be formed in the PDL **219** covering the pixel circuit unit PC. However, the one or more embodiments are not limited thereto. Thus, openings connected to the opening of the PDL **219** may be further formed in one or more of the passivation layer **217**, the interlayer insulating layer **215**, the gate insulating layer **213**, and the buffer layer **211**, so that transmittance in the opening may be further increased.

**[0102]** By way of summation and review, a display device has to include an optical mask and a sensor array to capture a gesture. The optical mask has a coded optical pattern so as to extract three-dimensional (3D) data by analyzing the captured gesture. In order to implement an interactive media by using a display device, i.e., a liquid crystal display (LCD) device may need to perform time-division switching between a display mode (implementation of a display image, and switching a backlight ON), and a capture mode (implementation of an optical mask pattern, and switching the backlight OFF). Thus, as a result of time-division switching, brightness of the display image deteriorates, and a structural interference occurs between the backlight and the sensor array.

**[0103]** In contrast, embodiments are directed to an organic light-emitting display device having a coded optical pattern array directly formed thereon. According to one or more embodiments, the coded optical pattern array is directly formed on a transparent panel of the organic light-emitting display device. Thus, it is not necessary to display a separate optical mask pattern. In the embodiments, since a backlight is not used, interactive media may be implemented that is slim, large, and free from structural interference.

**[0104]** According to one or more embodiments, by implementing the interactive media in the organic light-emitting

display device having a transmittance area, a display device may display an image and simultaneously capture a gesture of a user by the transmittance area. Thus, it is not necessary to perform time-division switching between a display mode and a capture mode as in the related art.

**[0105]** Exemplary embodiments have been disclosed herein, and although specific terms are employed, they are used and are to be interpreted in a generic and descriptive sense only and not for purpose of limitation.

**1.-8.** (canceled)

**9.** An organic light-emitting display device, comprising:

a first substrate including a plurality of pixel areas emitting light in a first direction, and a plurality of transmittance areas that are adjacent to respective ones of the pixel areas;

a second substrate facing the first substrate and encapsulating pixels on the first substrate;

an optical pattern array on the first substrate or the second substrate to correspond to the transmittance areas, the optical pattern array being configured to transmit or block external light depending on the transmittance area according to a coded pattern; and

a sensor array corresponding to the optical pattern array, the sensor array being arranged to receive external light in a second direction that is opposite to the first direction in which the light is emitted, the sensor array receiving the external light passing through the optical pattern array, wherein the coded pattern of the optical pattern array includes:

a first region corresponding to a first one of the transmittance areas, the first region allowing transmission of external light to the sensor array in the second direction, and

a second region corresponding to a second one of the transmittance areas, the second region blocking transmission of external light to the sensor array in the second direction, wherein the optical pattern array includes:

a transmittance pattern by which the external light is transmitted; and

a light-blocking pattern blocking the external light,

wherein the light-blocking pattern is implemented by a second electrode capable of reflecting light in the transmittance area.

**10.** The organic light-emitting display device as claimed in claim **9**, wherein the sensor array is on side portions of the second substrate and receives the external light passing through the transmittance pattern of the optical pattern array.

**11.** An organic light-emitting display device, comprising:

a first substrate including a plurality of pixel areas emitting light in a first direction, and a plurality of transmittance areas that are adjacent to respective ones of the pixel areas;

a second substrate facing the first substrate and encapsulating pixels on the first substrate;

an optical pattern array on the first substrate or the second substrate to correspond to the transmittance areas, the optical pattern array being configured to transmit or block external light depending on the transmittance area according to a coded pattern;

a sensor array corresponding to the optical pattern array, the sensor array being arranged to receive external light in a second direction that is opposite to the first direction in which the light is emitted, the sensor array receiving

the external light passing through the optical pattern array, wherein the coded pattern of the optical pattern array includes:

- a first region corresponding to a first one of the transmittance areas, the first region allowing transmission of external light to the sensor array in the second direction, and
- a second region corresponding to a second one of the transmittance areas, the second region blocking transmission of external light to the sensor array in the second direction;
- a pixel circuit unit on the first substrate, including one or more TFTs, and positioned in the pixel area;
- a first insulating layer covering at least the pixel circuit unit;
- a first electrode on the first insulating layer so as to be electrically connected to the pixel circuit unit, the first electrode being positioned in the pixel area and overlapping with the pixel circuit unit so as to cover the pixel circuit unit, the first electrode including a reflective layer that is capable of reflecting light and including a conductive material;
- a second insulating layer covering at least a portion of the first electrode;
- a second electrode capable of transmitting light so as to emit light in an opposite direction to a direction in which the first electrode reflects light, the second electrode facing the first electrode; and
- an organic layer interposed between the first electrode and the second electrode and including an EML.

**12.** The organic light-emitting display device as claimed in claim 11, wherein the reflective layer includes at least one metal of Ag, Mg, Al, Pt, Pd, Au, Ni, Nd, Ir, Cr, Li, Ca, Mo, and alloys thereof.

**13.** The organic light-emitting display device as claimed in claim 11, wherein the pixel includes a plurality of sub-pixels, and transmittance areas of two adjacent sub-pixels are connected to each other.

**14.** The organic light-emitting display device as claimed in claim 11, wherein the second insulating layer includes an opening at a position corresponding to the transmittance area.

**15.** The organic light-emitting display device as claimed in claim 11, wherein the optical pattern array includes:

a transmittance pattern by which the external light is transmitted; and

a light-blocking pattern blocking the external light, wherein the light-blocking pattern is implemented when a light-blocking layer capable of blocking light is on an insulating layer formed in the transmittance area.

**16.** The organic light-emitting display device as claimed in claim 15, wherein the sensor array is on side portions of the first substrate and receives the external light passing through the transmittance pattern of the optical pattern array.

**17.** The organic light-emitting display device as claimed in claim 15, wherein the light-blocking layer includes at least one metal of Ag, Mg, Al, Pt, Pd, Au, Ni, Nd, Ir, Cr, Li, Ca, Mo, and alloys thereof or includes a black matrix material.

**18.** The organic light-emitting display device as claimed in claim 9, further comprising:

- a pixel circuit unit on the first substrate, including one or more thin film transistors (TFTs), and positioned in the pixel area;
- a first insulating layer covering at least the pixel circuit unit;
- a first electrode on the first insulating layer so as to be electrically connected to the pixel circuit unit, the first electrode being positioned in the pixel area and being adjacent to the pixel circuit unit so as not to overlap with the pixel circuit unit, and including a transparent conductive material;
- a second insulating layer covering at least a portion of the first electrode;
- the second electrode capable of reflecting light so as to emit light toward the first electrode, the second electrode facing the first electrode and being positioned in the pixel area; and
- an organic layer interposed between the first electrode and the second electrode and including an emission layer (EML).

**19.** The organic light-emitting display device as claimed in claim 18, wherein the second electrode includes at least one metal of Ag, Mg, Al, Pt, Pd, Au, Ni, Nd, Ir, Cr, Li, Ca, Yb, and alloys thereof.

\* \* \* \* \*

专利名称(译)	有机发光显示装置		
公开(公告)号	<a href="#">US20150021589A1</a>	公开(公告)日	2015-01-22
申请号	US14/511249	申请日	2014-10-10
[标]申请(专利权)人(译)	三星显示有限公司		
申请(专利权)人(译)	三星DISPLAY CO. , LTD.		
当前申请(专利权)人(译)	三星DISPLAY CO. , LTD.		
[标]发明人	CHUNG JIN KOO YIM SANG HOON PARK CHAN YOUNG CHOI JUN HO KIM SEONG MIN		
发明人	CHUNG, JIN-KOO YIM, SANG-HOON PARK, CHAN-YOUNG CHOI, JUN-HO KIM, SEONG-MIN		
IPC分类号	H01L51/52 H01L27/32		
CPC分类号	H01L27/3211 H01L27/3234 H01L51/5221 H01L27/3272 H01L51/5218 H01L27/326 H01L27/3227 H01L27/323 H01L27/3262 H01L27/3269 H01L51/5203 H01L51/5237 H01L51/5281 H01L51/5284		
优先权	1020110037348 2011-04-21 KR		
其他公开文献	US9620576		
外部链接	<a href="#">Espacenet</a> <a href="#">USPTO</a>		

#### 摘要(译)

实施例可以公开一种有机发光显示装置，包括：第一基板，包括在第一方向上发光的像素区域；以及透射区域，与像素区域相邻并透射外部光；第二基板，面对第一基板，并将像素封装在第一基板上；第一基板或第二基板上的光学图案阵列对应于透射区域，光学图案阵列被配置为根据编码图案根据透射区域透射或阻挡外部光；对应于光学图案阵列的传感器阵列，传感器阵列沿与发射光的第一方向相反的第二方向排列，第二阵列接收穿过光学图案阵列的外部光。

